

PLAN DETAILS

Total	3684 sf
1 st Floor	1842 sf
Basement	1842 sf
Garage	907 sf
Front Porch	140 sf
Total Bedrooms	5
Total Bathrooms	3
Width	67' 0"
Depth	61' 0"

FIONA BASEMENT PLAN

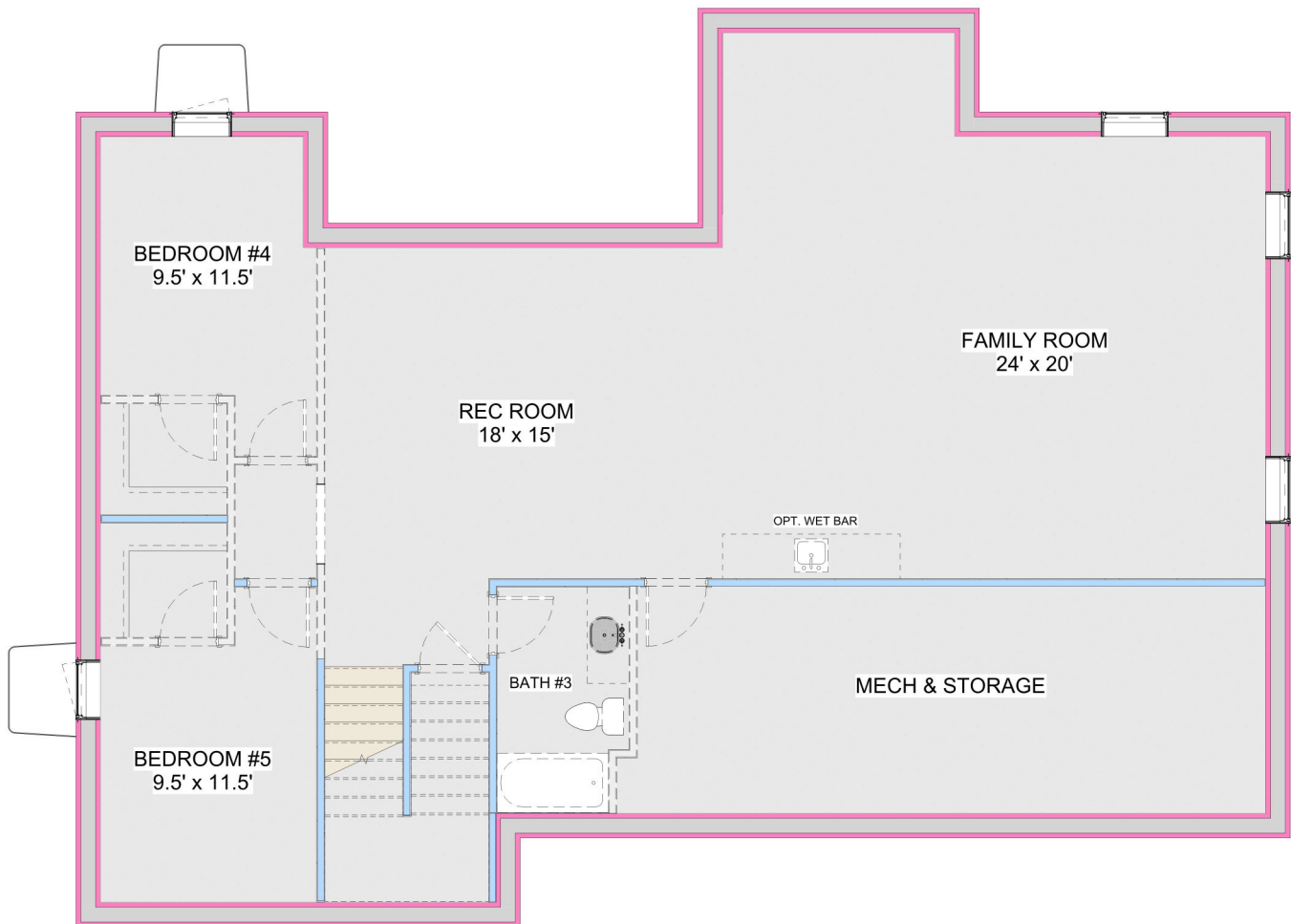
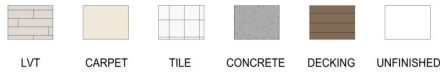

UNFINISHED BASEMENT LAYOUT

Pricing, specifications and terms may not be current and are subject to change without notice, Renderings are for illustrative purposes only and may show features/options not included in the price or available for an extra cost. Plan square footages and room dimensions may vary according to the elevation and plan selected. Contact R Henry Construction, Inc for more information.